

B (T0.12)

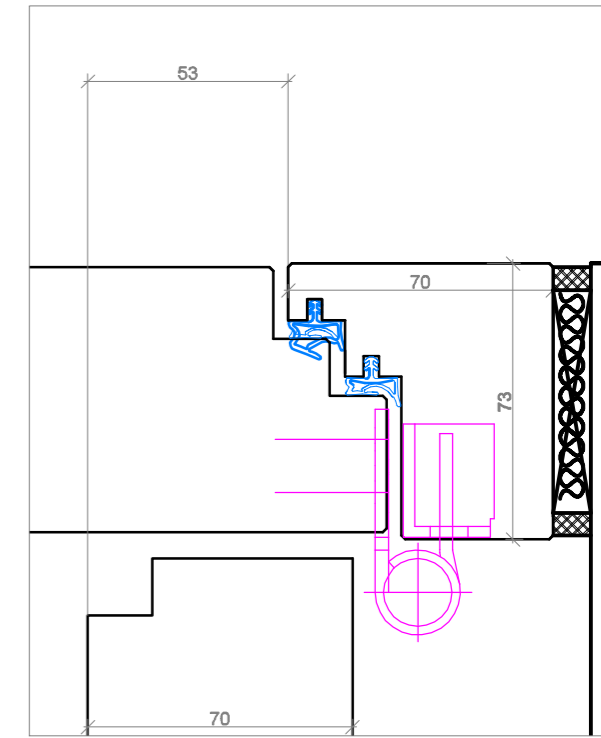

Systemplan, Besschlage, Masse etc. nach Turliste

Achtung: Montage-Lage laut Architekten Grundrissplan!!

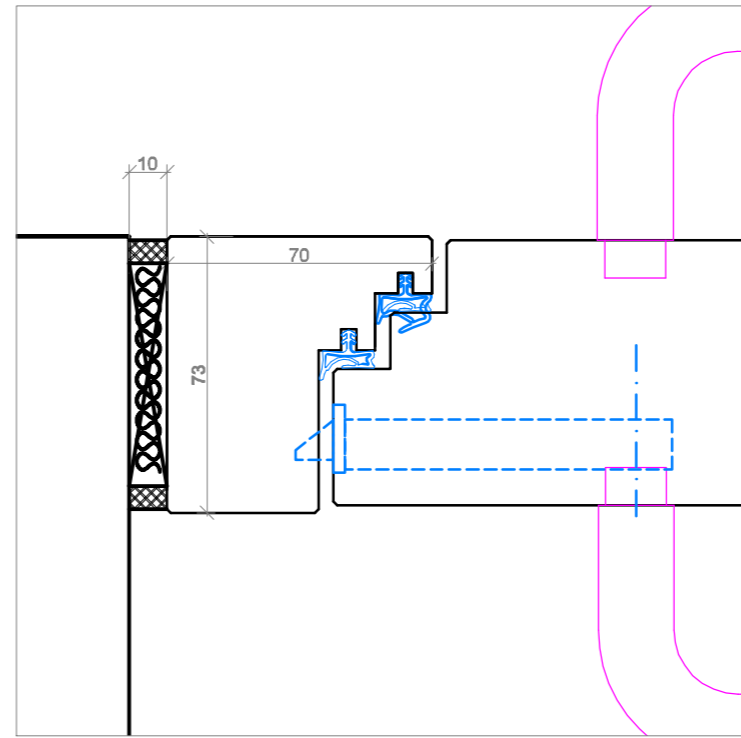
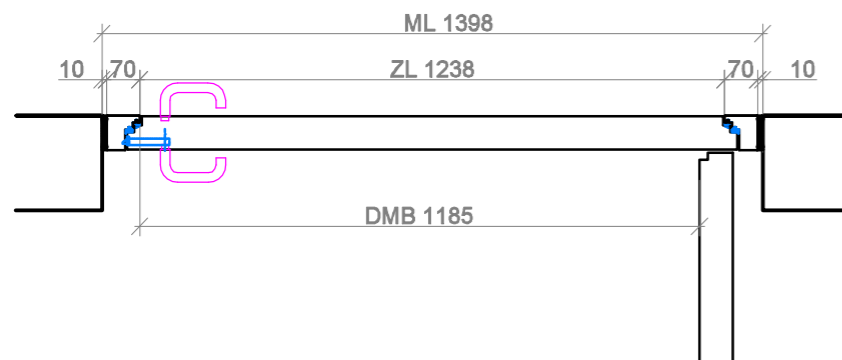
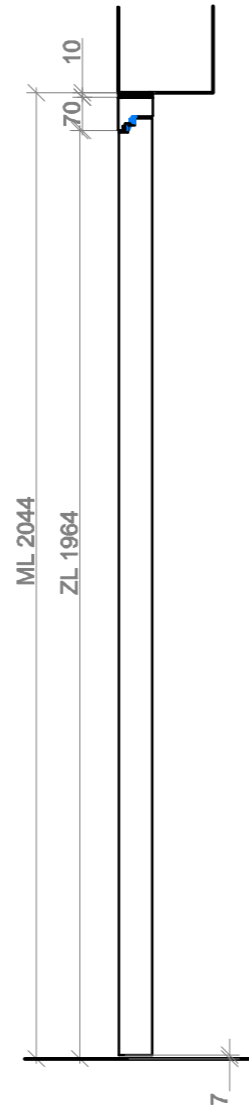
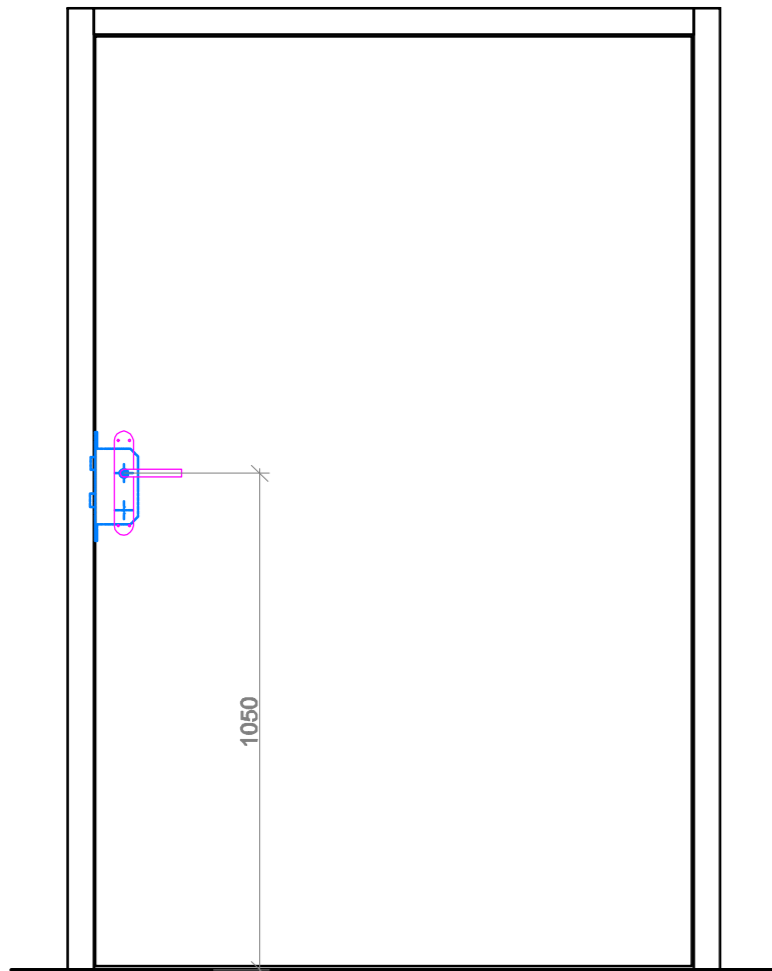

RS Suter AG
 im Wangli 4a
 8910 Affoltern am Albis
 Tel. 052 232 87 77
 info@rs-suter.ch

Tanzhaus
 Wasserwerkstr. 127a

B

Revision
 26.10.18

Plan Nr.

B

Auftrags Nr.
 18028

Datum
 18.9.18

Massstab
 1:16 / 1:2

Gezeichnet
 ps